

The new plasterboard GKD

Available from mai 2015

KEW[®] Kunststoffzeugnisse
GmbH Wilthen



suitable for plasterboards (limited suitability for gypsum and aircrete)

setting tool for
bit holder

form locking anchoring
directly in the materials' surface



self undercutting system
ensures optimal anchorage

6 mm broad setting tool quarantees
perfect placing of the anchor without pre- drilling*

Benefits at a glance

- ✓ simply setting without loss of load
- ✓ time saving fixing system consisting of plug and setting tool
- ✓ reusable setting tool
- ✓ self undercutting system ensures optimal anchorage

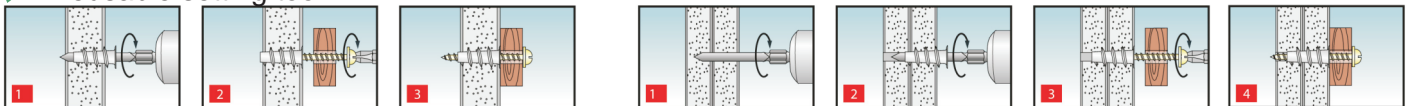

*board thickness exceeding 15 mm and aircrete require pre- drilling with the setting tool

Technical date

type	ref.- no. Old	qty. per box (pcs.)	outer carton (pcs.)	ref.- no. New
plasterboard plug with setting tool	32680	50+1	2700+54	38147
	32698			
	34561			
plasterboard plug with setting tool and chipboard screw	32681	50+1+50	1800+36+1800	38149
	32699			
	34561			
plasterboard plug	31075	200	3.200	38142
	34122			
plasterboard plug with setting tool	31077	200+1	3200+16	38146
	31423			
plasterboard plug loose	35171		6.500	38141
plasterboard plug loose with setting tool	35172		6500+1	38148
setting tool	31076	10		38278
	34124			
plasterboard plug with setting tool in red ecobox	34369	150+1		38145

Die aktuell gültigen Preise bleiben bestehen. Das Ihnen bekannte SB- Sortiment wird fortlaufend umgestellt. Die technischen Daten bleiben identisch. Bei weiteren Fragen informieren wir Sie gern:

Bestellen Sie jetzt!

FAX: +49 (0) 3592 385351

E- Mail an: sales@kew-werke.de